

Series: COMPACT-FAN Type D/DS
 EC-MOTOR
 double inlet
 with forward curved blades

FISCHBACH
 Luft- und Ventilatorentechnik GmbH

Type: D670/EM35

ERP KONFORM

CE -conform



manufacturer:
 Fischbach Luft- und Ventilatorentechnik GmbH
 Am Hellerberg 22-24
 D-57290 Neunkirchen
 phone: ++49(0)2735/777-0
 telefax: ++49(0)2735/770-625
 internet: www.fischbach-luft.de
 email: info@fischbach-luft.de

Technical Data

| | | |
|------------------------|-------------------|----|
| weight: | (kg) | 22 |
| material housing: | steel, galvanized | |
| material impeller: | steel, galvanized | |
| direction of rotation: | left | |
| protection class: | IP 65 | |
| insulation class: | F | |
| motor protection: | thermal contact | |

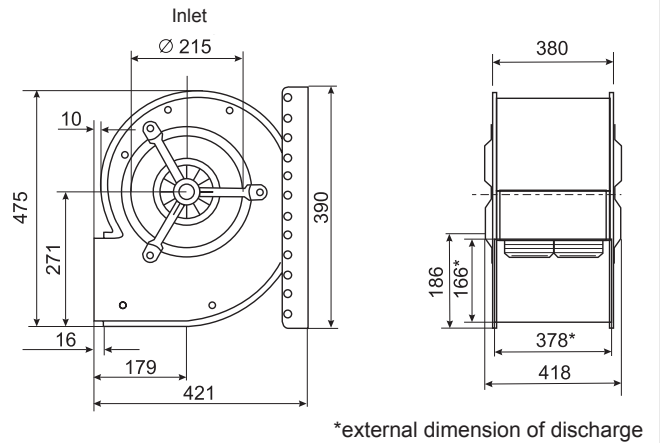

**connection plan*
 FFU-EC 230**

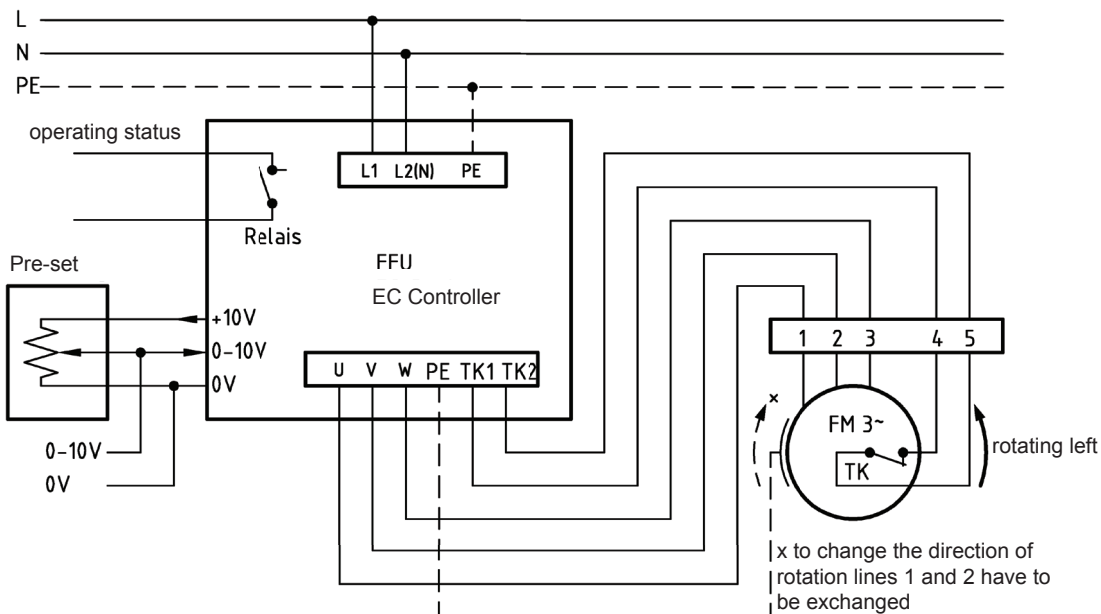

* Connection only according to the enclosed technical documentation.

the silent one



Series: COMPACT-FAN Type D/DS
EC-MOTOR
 double inlet
 with forward curved blades

FISCHBACH
 Luft- und Ventilatorentechnik GmbH

Type: D670/EM35

Erp 2013 2015 2018 x

Performance data

| | | |
|-------------------------|--------|------------|
| main voltage: | (V) | 230 (1~) |
| frequency: | (Hz) | 50 |
| current max.: | (A) | 9,2 |
| power input max.: | (kW) | 1,4 |
| air flow volume max.: | (m³/h) | 5488 |
| statical pressure max.: | (Pa) | 462 |
| speed max.: | (rpm) | 1350 |
| supply air temperature: | (°C) | -25... +70 |
| capacitor: | (µF) | - |

ErP-Data:

| | | |
|--|---|------------|
| total efficiency fan (η_e): | (%) | 48,2 |
| installation category: | | A |
| efficiency category: | | static |
| efficiency grade: N | (%) | 42 |
| target efficiency (η_{target}): | (%) | 38,3 |
| speed controller | | yes |
| year of manufacturing | | since 2015 |
| manufacturer: | Fischbach Luft- und Ventilatorentechnik GmbH D-57290 Neunkirchen / HRB 5804 Siegen | |
| order no. | | 18111910 |
| power input: | (kW) | 0,55 |
| air flow volume: | (m³/h) | 2224 |
| statical pressure: | (Pa) | 388 |
| speed: | (rpm) | 1350 |
| specific ratio: | | 1 |

disassembling/recycling/disposal: see page decommission
 installation/operation/maintenance: see operating and mounting instructions
 measurement for determination of efficiency without additional items

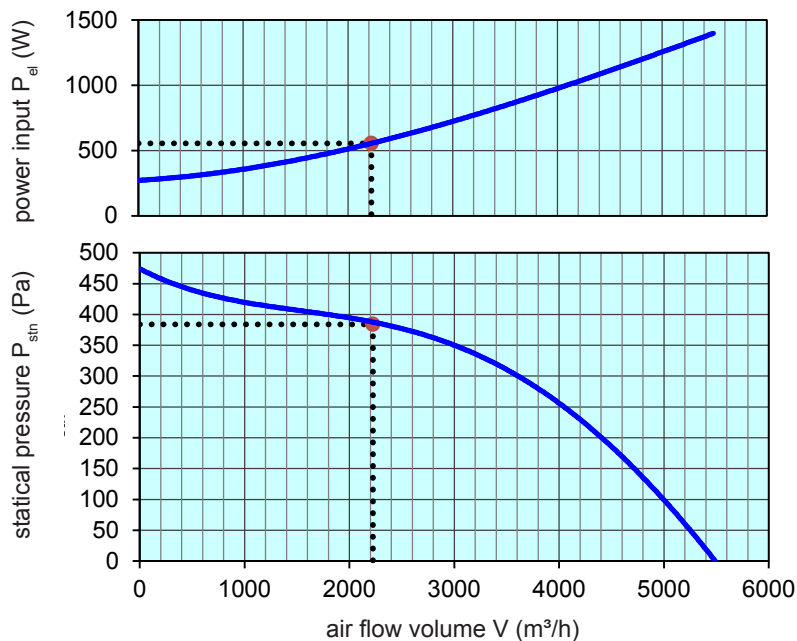

| control with | type | order-Nr. |
|--|-------------|-----------|
| FISCHBACH-frequency-converter | FFU1-21-2.2 | 63720 |
| FISCHBACH-Pre-set 0-10V (optional accessories) | FS 10 | 69460 |

Technical documentation according to page: **General information**